

PART NO.	DRIVE SIZE	"T" THREAD SIZE
023-200-A	.104 SQUARE	7/8-18
023-200-B	.150 SQUARE	7/8-18
023-200-C	.187 SQUARE	7/8-18
023-200-D	.152 ROUND	7/8-18
023-200-E	.187 ROUND	7/8-18
023-200-F	.203 ROUND	7/8-18
023-200-G	DIN	22MM X 1.5
023-200-H	.187 ROUND	22MM X 1.5

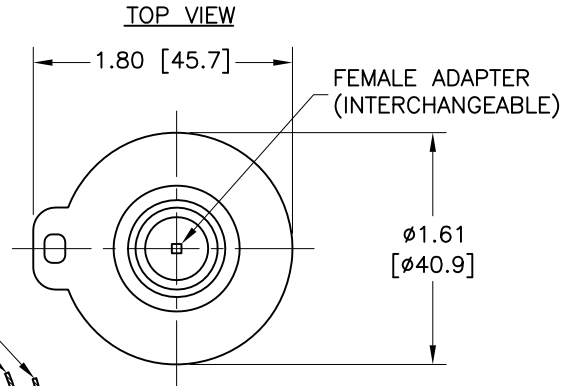

- ④ TO COIL #1 [YELLOW 14" [356mm]
RED 12" [305mm]
- ④ TO COIL #2 [BLACK/RED 8" [203mm]
BLACK 10" [254mm]

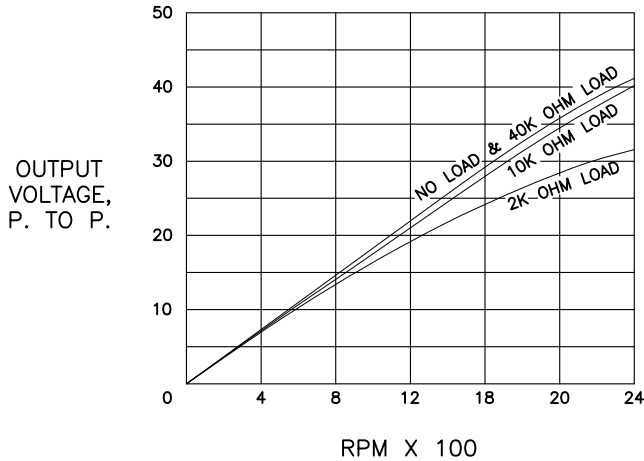
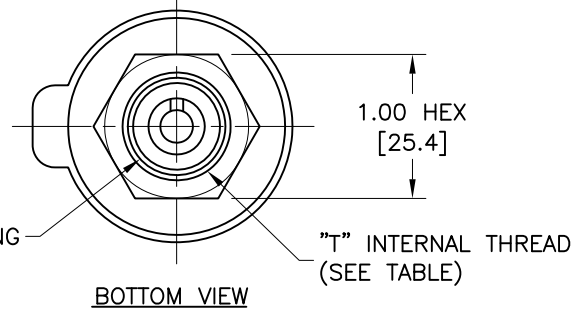
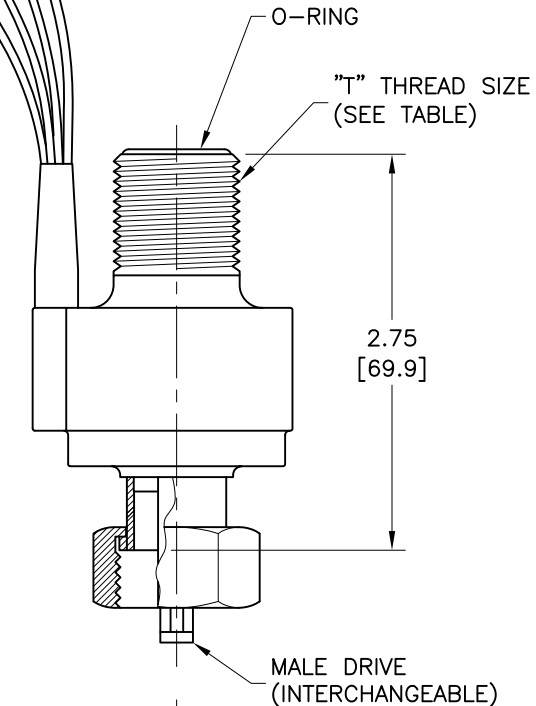

SPECIFICATIONS:

1. FREQUENCY: 8 PULSES PER REVOLUTION.
2. DC SOURCE IMPEDANCE: 160 OHMS ±10 OHMS.
3. HOUSING MATERIAL: GLASS FILLED NYLON.
4. BEARING: DOUBLE-OILITE.
5. LEAD WIRES: 20 AWG., 19 STRANDED.

NOTES:

1. SINGLE OUTPUT GENERATOR ALSO AVAILABLE.
2. SPECIAL LENGTHS AND CONNECTORS AVAILABLE.
3. AVAILABLE IN DIN, M22 X 1.5 METRIC THREAD.

- ④. NO POLARITY FOR EACH LEAD WIRE PAIR. ON EACH PAIR OF LEAD WIRES: ONE LEAD WIRE TO SIGNAL, THE OTHER LEAD WIRE TO GROUND.

B

REVISIONS					TOLERANCES	
REV.	DESCRIPTION	EO#	DATE	BY	UNLESS OTHERWISE SPECIFIED:	
A	REVISED PER ECO	ECO 403	06/18/08	EGM	DIMENSIONS ARE IN INCHES, METRIC EQUIVALENTS ARE IN [BRACKETS]:	
B	REVISED PER ECO	ECO 740	04/11/17	JAG	.X = .030 [0.76] .XX = .010 [0.25] .XXX = .005 [0.13] FRACTIONS = 1/32 ANGLES = ±1°	
					SCALE:	3/4

HI HEWITT INDUSTRIES OF LOS ANGELES

TITLE: SIGNAL GENERATOR, DUAL	
DRAWN BY: E.MARIANO	PART NO. 023-200-X
APPR. BY: H.J.FUJITA	
DATE: 06/18/08	SHEET 1 OF 1